

Specifications

- Current rating:3A AC,DC
- Voltage rating:250V AC,DC
- Temperature range:-25°C~+85°C
- Contact resistance:30mΩMax.
- Insulation resistance:650MΩMin.
- Withstanding voltage:800V AC/minute
- *Compliant with RoHS and REACH*
- *Meet the HF/Halogen Free,need to customize*
- *Contact HDGC for details*

Assembly layout

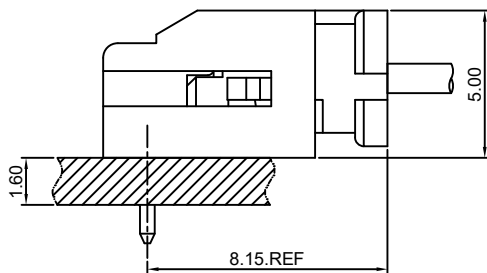

DIP TYPE

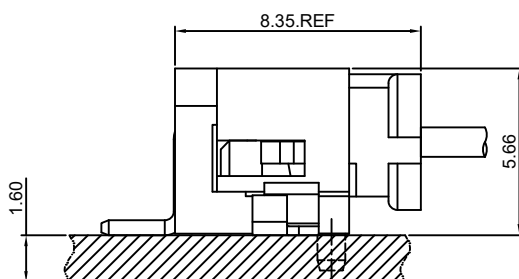
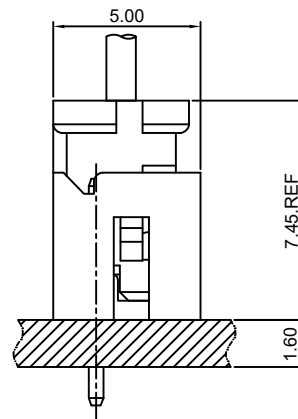

SMT TYPE

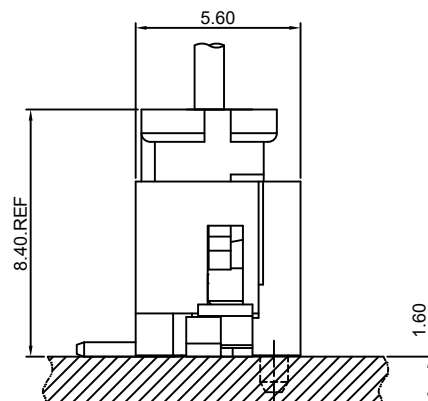



HDGC2011 Series 2.00mm (.079") Pitch Wire to Board and Wire to Wire Connector

HDGC2011-T

2.00mm pitch Crimp Terminal

Reference Informations:

*Used in HDGC2011H-XP series Housing

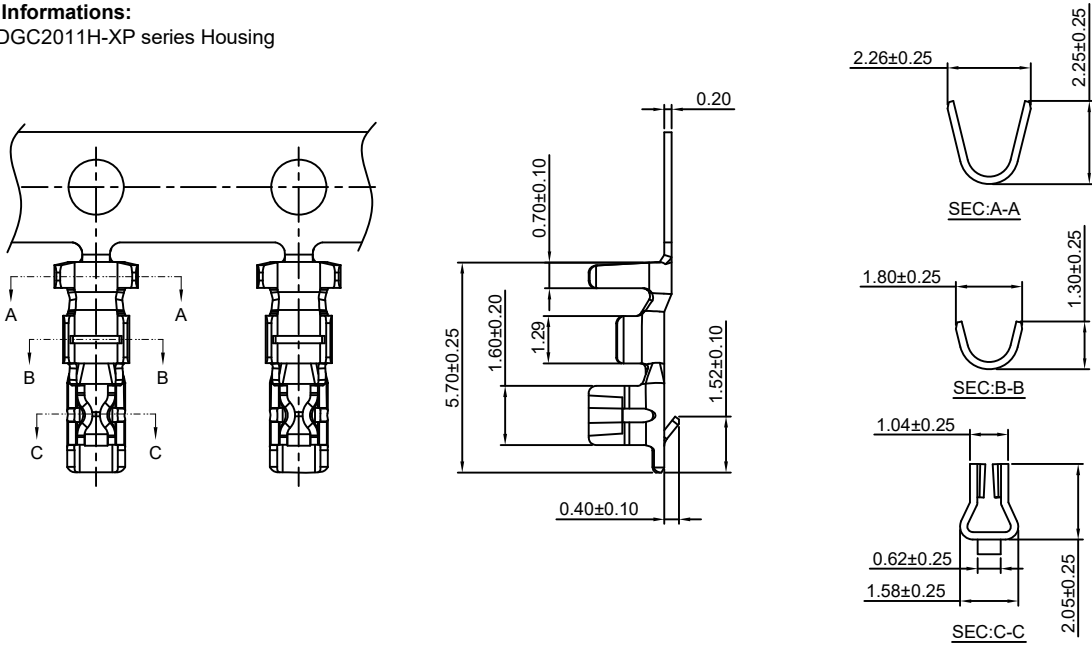

Ordering information & Specifications:

Unit:mm

Part NO.	Wire Range	Insulation O.D.	Material	Finish	Qty/reel
HDGC2011-TP	AWG#22-#28	1.45mm(max)	Phosphor Bronze	Tin over Nickel	10,000 PCS
HDGC2011-GP	AWG#22-#28	1.45mm(max)	Phosphor Bronze	Gold over Nickel	10,000 PCS

Optional Gold plating available but MOQ requested

HDGC2011-T-A

2.00mm pitch Crimp Terminal

Reference Informations:

*Used in HDGC2011HA-2xXP series Housing

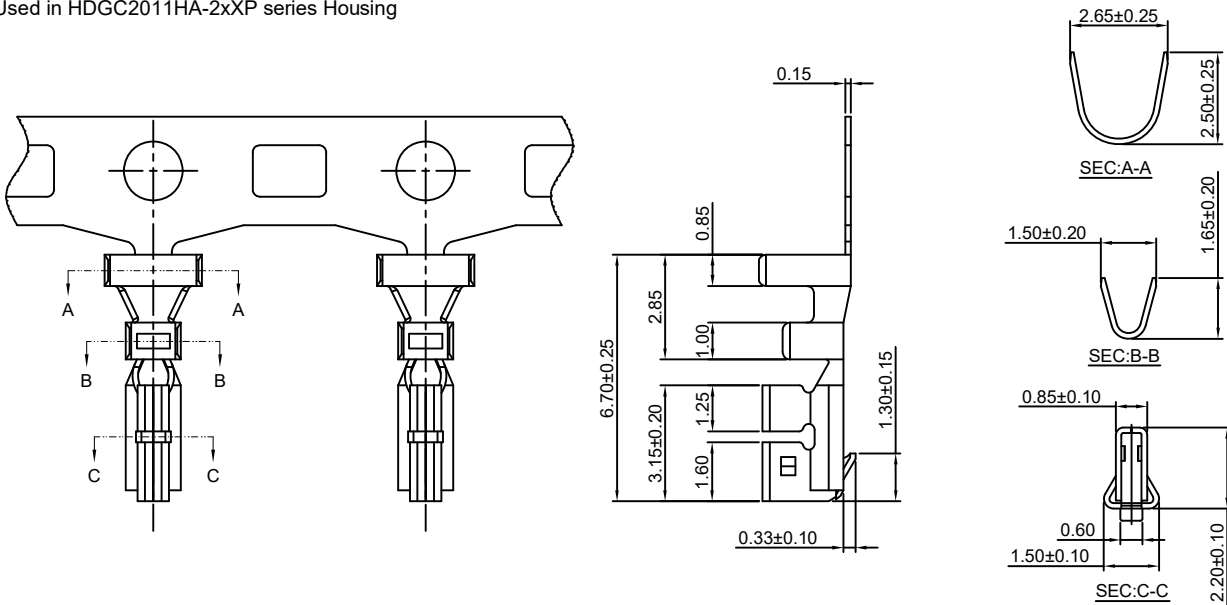

Ordering information & Specifications:

Unit:mm

Part NO.	Wire Range	Insulation O.D.	Material	Finish	Qty/reel
HDGC2011-TP-A	AWG#22-#28	1.45mm(max)	Phosphor Bronze	Tin over Nickel	10,000 PCS
HDGC2011-GP-A	AWG#22-#28	1.45mm(max)	Phosphor Bronze	Gold over Nickel	10,000 PCS

Optional Gold plating available but MOQ requested



HDGC2011 Series 2.00mm (.079") Pitch Wire to Board and Wire to Wire Connector

HDGC2011M-T

2.00mm pitch Crimp Terminal

Reference Informations:

*Used in HDGC2011HM-XP series Housing

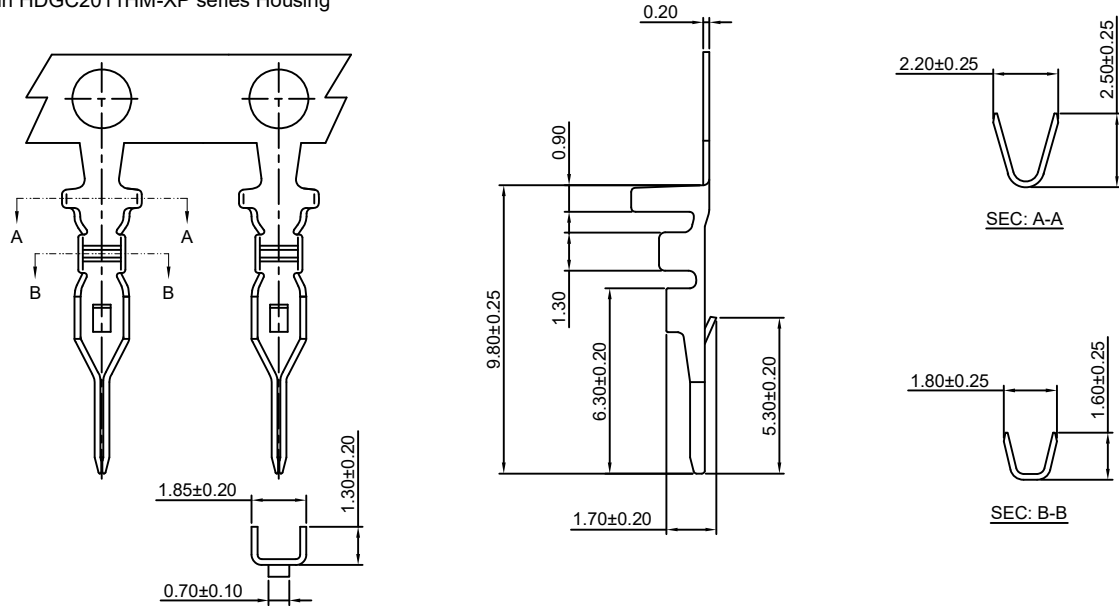

Ordering information & Specifications:

Unit:mm

Part NO.	Wire Range	Insulation O.D.	Material	Finish	Qty/reel
HDGC2011M-TP	AWG#24-#28	1.45mm(max)	Phosphor Bronze	Tin over Nickel	10,000 PCS
HDGC2011M-GP	AWG#24-#28	1.45mm(max)	Phosphor Bronze	Gold over Nickel	10,000 PCS

Optional Gold plating available but MOQ requested

HDGC2011H-XP

2.00mm pitch Housing

Reference Informations:

*Material:Nylon 66,UL94V-0

*Suitable HDGC2011-T series Terminal

*Mates with HDGC2011WV,WR,WV-S,WR-S-XP, HDGC2011WV-S-F,WR-S-F-XP series Wafer

*Color:Black

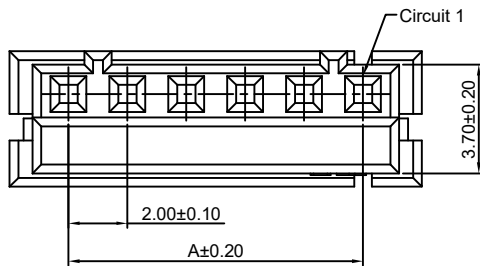
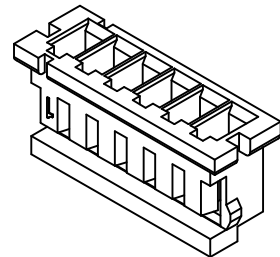

Ordering Information:

HDGC2011H-XP - ***
1 2

1.Part No.

2.Material:

(Blank):Nylon 66,UL94V-0

GWT:Nylon 66,UL94V-0 GWT 750 °C

Ordering Information & Dimensions:

PART NO.	Dimensions	
	A	B
2P	2.00	6.00
3P	4.00	8.00
4P	6.00	10.00
5P	8.00	12.00
6P	10.00	14.00
7P	12.00	16.00
8P	14.00	18.00
9P	16.00	20.00
10P	18.00	22.00
11P	20.00	24.00
12P	22.00	26.00
13P	24.00	28.00
14P	26.00	30.00
15P	28.00	32.00

Unit: mm

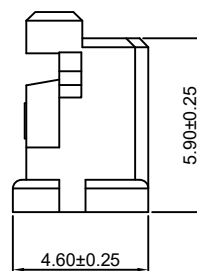
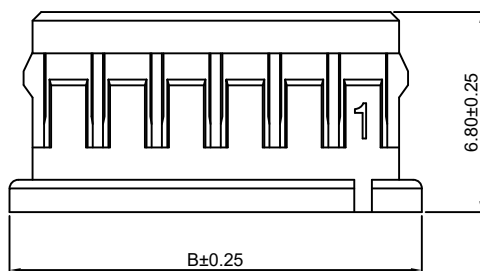



HDGC2011 Series 2.00mm (.079") Pitch Wire to Board and Wire to Wire Connector

HDGC2011HM-XP

2.00mm pitch Housing

Reference Informations:

- *Material:Nylon 66,UL94V-0
- *Suitable HDGC2011M-T series Terminal
- *Mates with HDGC2011H-XP series Housing
- *Color:Black

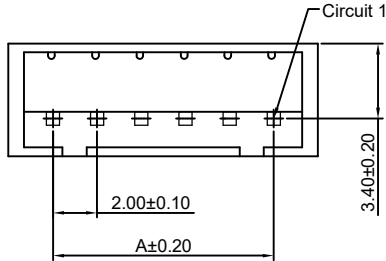

Ordering Information:
 HDGC2011HM-XP - ***
 1 2

- 1.Part No.
 2.Material:
 (Blank):Nylon 66,UL94V-0
 GWT:Nylon 66,UL94V-0 GWT 750 °C

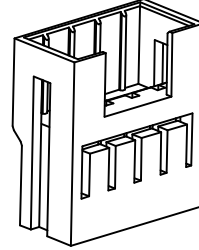

Ordering Information & Dimensions:

PART NO.	Dimensions	
	A	B
2P	2.00	6.00
3P	4.00	8.00
4P	6.00	10.00
5P	8.00	12.00
6P	10.00	14.00
7P	12.00	16.00
8P	14.00	18.00
9P	16.00	20.00
10P	18.00	22.00
11P	20.00	24.00
12P	22.00	26.00
13P	24.00	28.00
14P	26.00	30.00
15P	28.00	32.00

Unit: mm

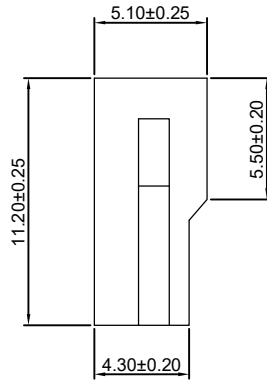
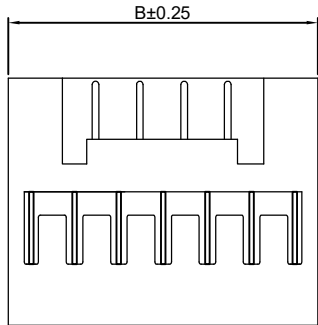

HDGC2011HA-2xXP

2.00mm pitch Dual Row Housing

Reference Informations:

- *Material:Nylon 66,UL94V-0
- *Suitable HDGC2011-T-A series Terminal
- *Mates with HDGC2011WVA, WRA-2xXP series Dual Row Wafer
- *Color:White

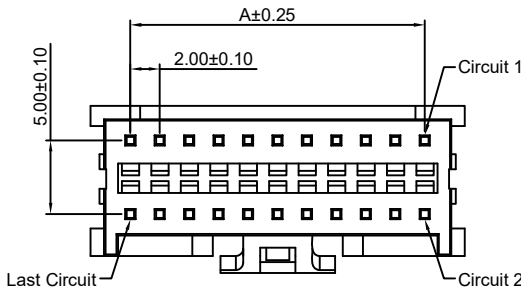

Ordering Information:
 HDGC2011HA-2xXP - ***
 1 2

- 1.Part No.
 2.Material:
 (Blank):Nylon 66,UL94V-0
 GWT:Nylon 66,UL94V-0 GWT 750 °C

Ordering Information & Dimensions:

PART NO.	Dimensions				
	A	B	C	D	E
2x4P	6.00	11.40	9.60	4.70	8.40
2x5P	8.00	13.40	11.60	4.70	8.40
2x6P	10.00	15.40	13.60	7.80	11.60
2x7P	12.00	17.40	15.60	7.80	11.60
2x8P	14.00	19.40	17.60	7.80	11.60
2x9P	16.00	21.40	19.60	7.80	11.60
2x10P	18.00	23.40	21.60	7.80	11.60
2x11P	20.00	25.40	23.60	7.80	11.60
2x12P	22.00	27.40	25.60	7.80	11.60
2x13P	24.00	29.40	27.60	7.80	11.60
2x14P	26.00	31.40	29.60	7.80	11.60
2x15P	28.00	33.40	31.60	7.80	11.60
2x16P	30.00	35.40	33.60	7.80	11.60
2x17P	32.00	37.40	35.60	7.80	11.60
2x18P	34.00	39.40	37.60	7.80	11.60
2x19P	36.00	41.40	39.60	7.80	11.60
2x20P	38.00	43.40	41.60	7.80	11.60

Unit: mm

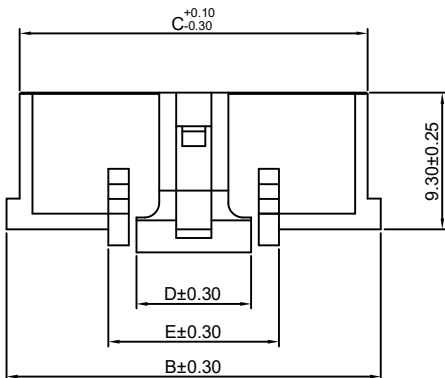



HDGC2011 Series 2.00mm (.079") Pitch Wire to Board and Wire to Wire Connector

HDGC2011WV-XP

2.00mm pitch 180° Wafer

Reference Informations:

- *Material: Pin: Brass/Gold over Nickel
Insulator: Nylon 66, UL94V-0
- *Mates with HDGC2011H-XP series Housing
- *Color: Black

Ordering Information:

HDGC2011WV-XP - ^{***}/₂ - ^{**}/₃

- Part No.
- Material:
(Blank): Nylon 66, UL94V-0
GWT: Nylon 66, UL94V-0, GWT 750 °C
- Finish:
(blank): Tin over Nickel
G: Gold over Nickel

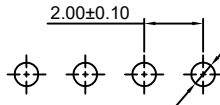
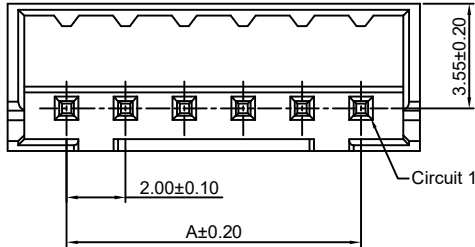
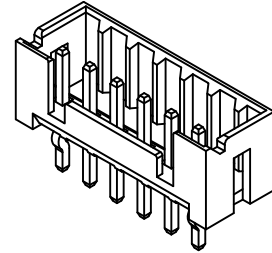

P.C.B LAYOUT

Ordering Information & Dimensions:

PART NO.	Dimensions	
	A	B
2P	2.00	6.00
3P	4.00	8.00
4P	6.00	10.00
5P	8.00	12.00
6P	10.00	14.00
7P	12.00	16.00
8P	14.00	18.00
9P	16.00	20.00
10P	18.00	22.00
11P	20.00	24.00
12P	22.00	26.00
13P	24.00	28.00
14P	26.00	30.00
15P	28.00	32.00

Unit: mm

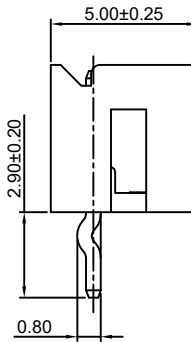
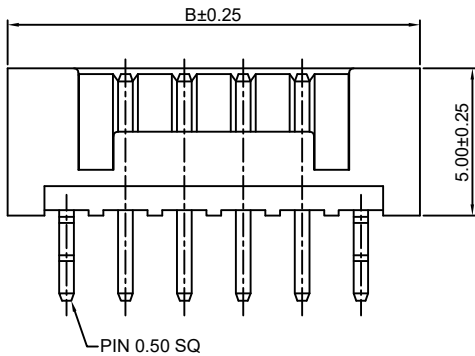

HDGC2011WR-XP

2.00mm pitch 90° Wafer

Reference Informations:

- *Material: Pin: Brass/Gold over Nickel
Insulator: Nylon 66, UL94V-0
- *Mates with HDGC2011H-XP series Housing
- *Color: Black

Ordering Information:

HDGC2011WR-XP - ^{***}/₂ - ^{**}/₃

- Part No.
- Material:
(Blank): Nylon 66, UL94V-0
GWT: Nylon 66, UL94V-0, GWT 750 °C
- Finish:
(blank): Tin over Nickel
G: Gold over Nickel

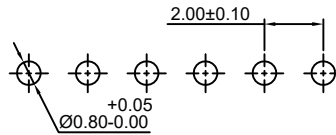
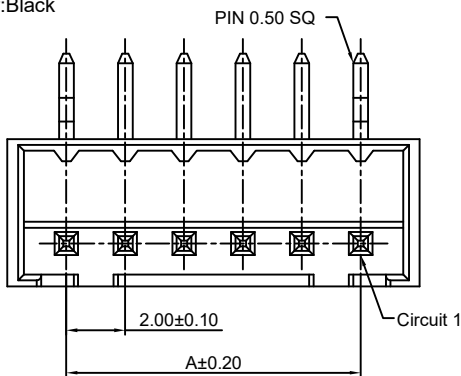
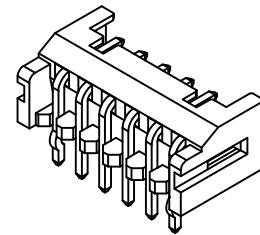

P.C.B LAYOUT

Ordering Information & Dimensions:

PART NO.	Dimensions	
	A	B
2P	2.00	6.00
3P	4.00	8.00
4P	6.00	10.00
5P	8.00	12.00
6P	10.00	14.00
7P	12.00	16.00
8P	14.00	18.00
9P	16.00	20.00
10P	18.00	22.00
11P	20.00	24.00
12P	22.00	26.00
13P	24.00	28.00
14P	26.00	30.00
15P	28.00	32.00

Unit: mm

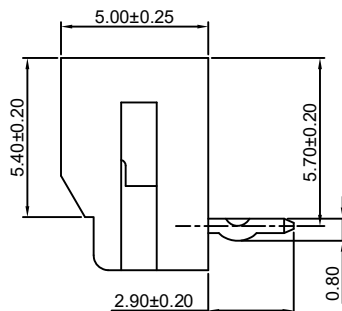
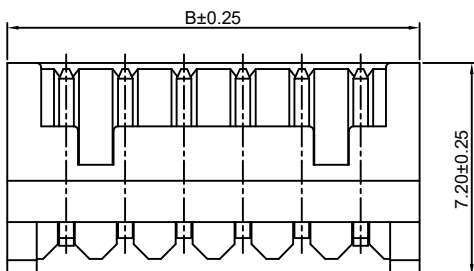



HDGC2011 Series 2.00mm (.079") Pitch Wire to Board and Wire to Wire Connector

HDGC2011WV-S-XP

2.00mm pitch 180° Wafer - SMT TYPE

Reference Informations:

- *Material: Pin: Brass/Tin over Nickel
Solder Tabs: Brass/Tin over Nickel
Insulator: Nylon 6T, UL94V-0
- *Mates with HDGC2011H-XP series Housing
- *Color: Ivory

Ordering Information:

HDGC2011WV-S-XP - *** - **
1 2 3

1. Part No.
2. Material:
(Blank): Nylon 6T, UL94V-0
GWT: Nylon 6T, UL94V-0, GWT 750 °C
3. Finish:
(blank): Tin over Nickel
G: Gold over Nickel

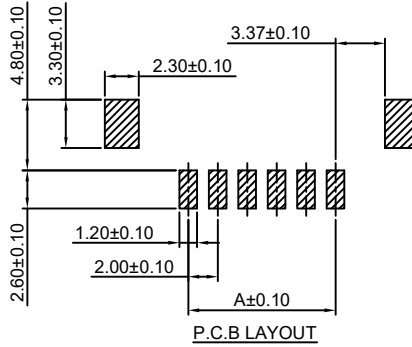
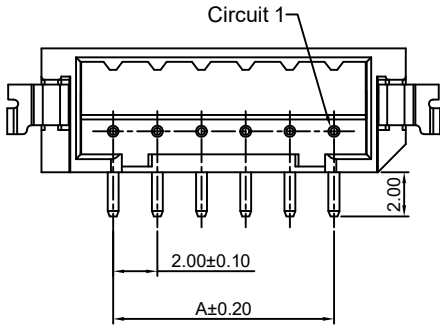
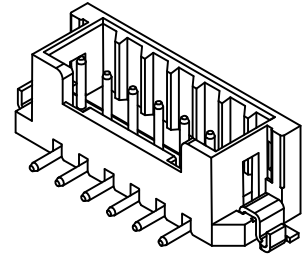

Ordering Information & Dimensions:

PART NO.	Dimensions	
	A	B
2P	2.00	8.50
3P	4.00	10.50
4P	6.00	12.50
5P	8.00	14.50
6P	10.00	16.50
7P	12.00	18.50
8P	14.00	20.50
9P	16.00	22.50
10P	18.00	24.50
11P	20.00	26.50
12P	22.00	28.50
13P	24.00	30.50
14P	26.00	32.50
15P	28.00	34.50

Unit: mm

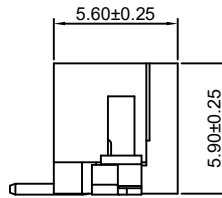
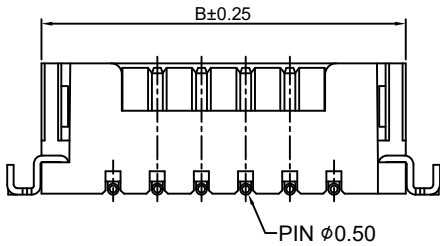

HDGC2011WR-S-XP

2.00mm pitch 90° Wafer - SMT TYPE

Reference Informations:

- *Material: Pin: Brass/Tin over Nickel
Solder Tabs: Brass/Tin over Nickel
Insulator: Nylon 6T, UL94V-0
- *Mates with HDGC2011H-XP series Housing
- *Color: Ivory

Ordering Information:

HDGC2011WR-S-XP - *** - **
1 2 3

1. Part No.
2. Material:
(Blank): Nylon 6T, UL94V-0
GWT: Nylon 6T, UL94V-0, GWT 750 °C
3. Finish:
(blank): Tin over Nickel
G: Gold over Nickel

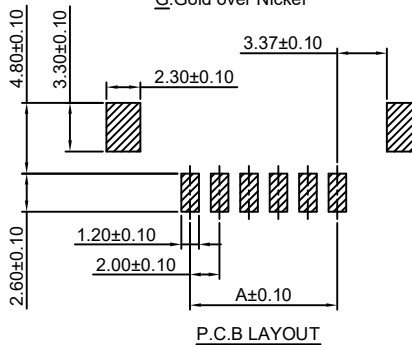
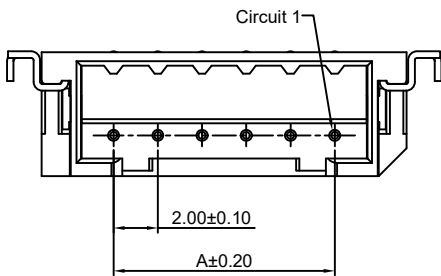
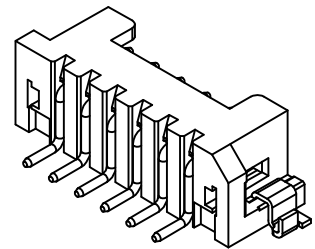

Ordering Information & Dimensions:

PART NO.	Dimensions	
	A	B
2P	2.00	8.50
3P	4.00	10.50
4P	6.00	12.50
5P	8.00	14.50
6P	10.00	16.50
7P	12.00	18.50
8P	14.00	20.50
9P	16.00	22.50
10P	18.00	24.50
11P	20.00	26.50
12P	22.00	28.50
13P	24.00	30.50
14P	26.00	32.50
15P	28.00	34.50

Unit: mm

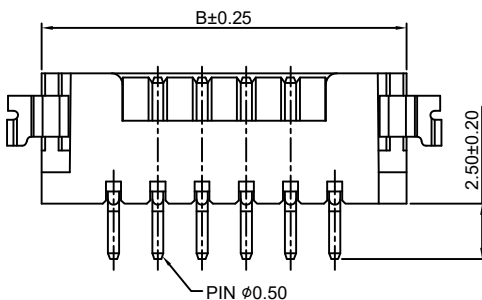



HDGC2011 Series 2.00mm (.079") Pitch Wire to Board and Wire to Wire Connector

HDGC2011WV-S-F-XP

2.00mm pitch 180° Wafer Boss-SMT TYPE

Reference Informations:

- *Material: Pin: Brass/Tin over Nickel
Solder Tabs: Brass/Tin over Nickel
Insulator: Nylon 6T, UL94V-0
- *Mates with HDGC2011H-XP series Housing
- *Color: Ivory

Ordering Information:

HDGC2011WV-S-F-XP - *** - **
1 2 3

1. Part No.
2. Material:
(Blank): Nylon 6T, UL94V-0
GWT: Nylon 6T, UL94V-0, GWT 750 °C
3. Finish:
(blank): Tin over Nickel
G: Gold over Nickel

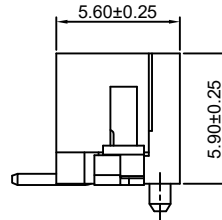
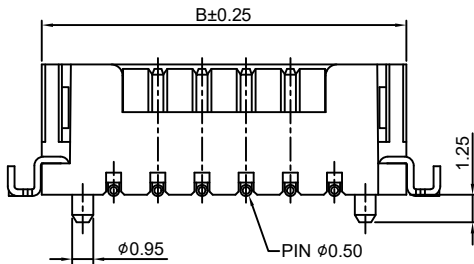
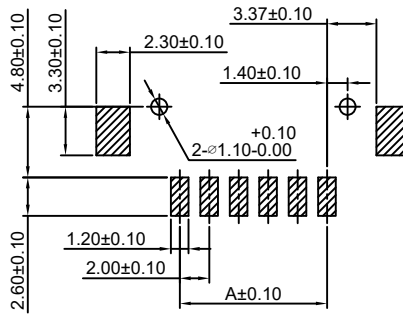
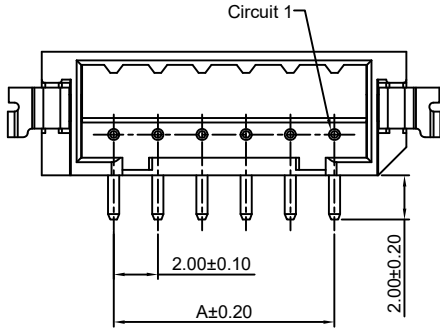
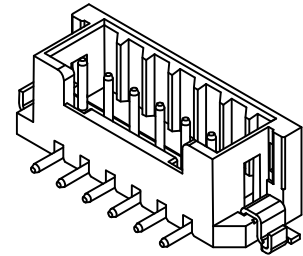

Ordering Information & Dimensions:

PART NO.	Dimensions	
	A	B
2P	2.00	8.50
3P	4.00	10.50
4P	6.00	12.50
5P	8.00	14.50
6P	10.00	16.50
7P	12.00	18.50
8P	14.00	20.50
9P	16.00	22.50
10P	18.00	24.50
11P	20.00	26.50
12P	22.00	28.50
13P	24.00	30.50
14P	26.00	32.50
15P	28.00	34.50

Unit: mm

HDGC2011WR-S-F-XP

2.00mm pitch 90° Wafer Boss-SMT TYPE

Reference Informations:

- *Material: Pin: Brass/Tin over Nickel
Solder Tabs: Brass/Tin over Nickel
Insulator: Nylon 6T, UL94V-0
- *Mates with HDGC2011H-XP series Housing
- *Color: Ivory

Ordering Information:

HDGC2011WR-S-F-XP - *** - **
1 2 3

1. Part No.
2. Material:
(Blank): Nylon 6T, UL94V-0
GWT: Nylon 6T, UL94V-0, GWT 750 °C
3. Finish:
(blank): Tin over Nickel
G: Gold over Nickel

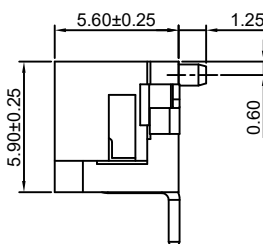
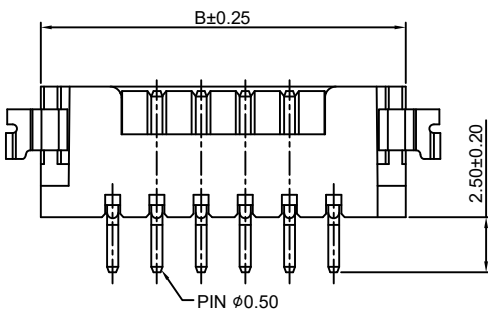
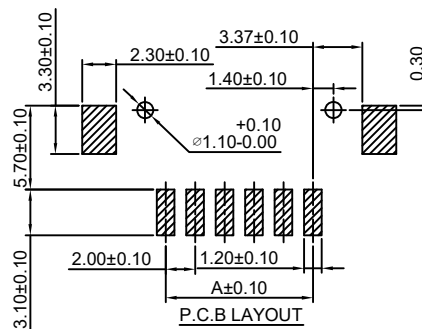
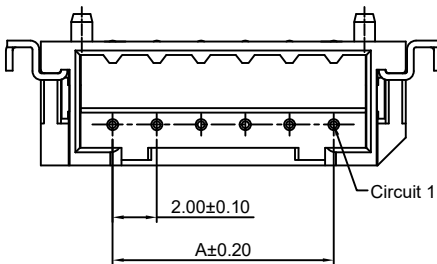
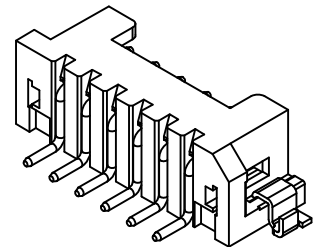

Ordering Information & Dimensions:

PART NO.	Dimensions	
	A	B
2P	2.00	8.50
3P	4.00	10.50
4P	6.00	12.50
5P	8.00	14.50
6P	10.00	16.50
7P	12.00	18.50
8P	14.00	20.50
9P	16.00	22.50
10P	18.00	24.50
11P	20.00	26.50
12P	22.00	28.50
13P	24.00	30.50
14P	26.00	32.50
15P	28.00	34.50

Unit: mm



HDGC2011 Series 2.00mm (.079") Pitch Wire to Board and Wire to Wire Connector

HDGC2011WVA-2xXP

2.00mm pitch 180° Dual Row Wafer

Reference Informations:

- *Material: Pin: Brass/Tin over Nickel
Insulator: PBT, UL94V-0
- *Mates with HDGC2011HA-2xXP series Dual Row Housing
- *Color: White

Ordering Information:

- HDGC2011WVA-2xXP - *** - **
1 2 3
- Part No.
 - Material:
(Blank): PBT, UL94V-0
GWT: PBT, UL94V-0, GWT 750°C
 - Finish:
(blank): Tin over Nickel
G: Gold over Nickel

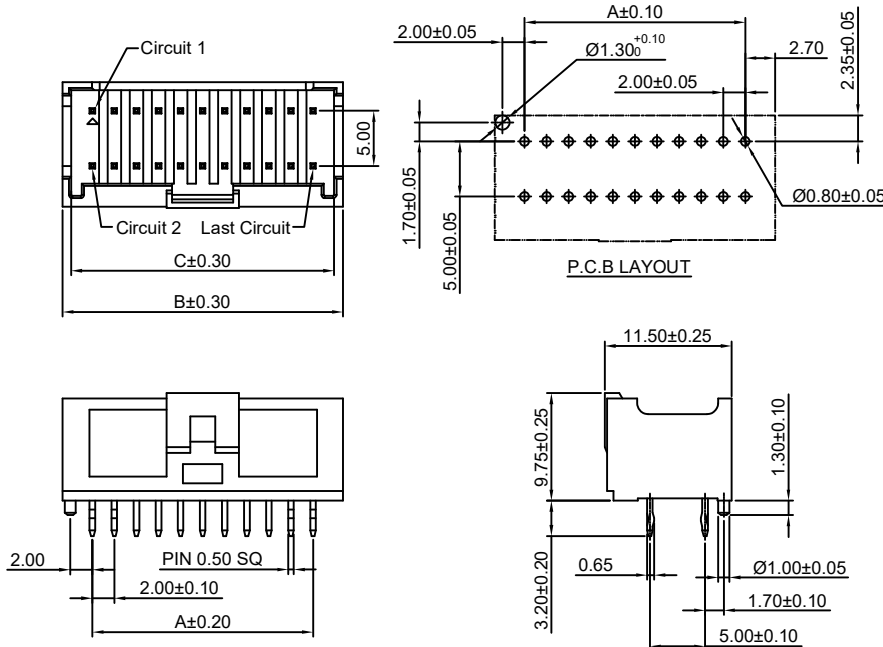

Ordering Information & Dimensions:

PART NO.	Dimensions		
	A	B	C
2x4P	6.00	11.40	9.80
2x5P	8.00	13.40	11.80
2x6P	10.00	15.40	13.80
2x7P	12.00	17.40	15.80
2x8P	14.00	19.40	17.80
2x9P	16.00	21.40	19.80
2x10P	18.00	23.40	21.80
2x11P	20.00	25.40	23.80
2x12P	22.00	27.40	25.80
2x13P	24.00	29.40	27.80
2x14P	26.00	31.40	29.80
2x15P	28.00	33.40	31.80
2x16P	30.00	35.40	33.80
2x17P	32.00	37.40	35.80
2x18P	34.00	39.40	37.80
2x19P	36.00	41.40	39.80
2x20P	38.00	43.40	41.80

Unit: mm

HDGC2011WRA-2xXP

2.00mm pitch 90° Dual Row Wafer

Reference Informations:

- *Material: Pin: Brass/Tin over Nickel
Insulator: PBT, UL94V-0
- *Mates with HDGC2011HA-2xXP series Dual Row Housing
- *Color: White

Ordering Information:

- HDGC2011WRA-2xXP - *** - **
1 2 3
- Part No.
 - Material:
(Blank): PBT, UL94V-0
GWT: PBT, UL94V-0, GWT 750°C
 - Finish:
(blank): Tin over Nickel
G: Gold over Nickel

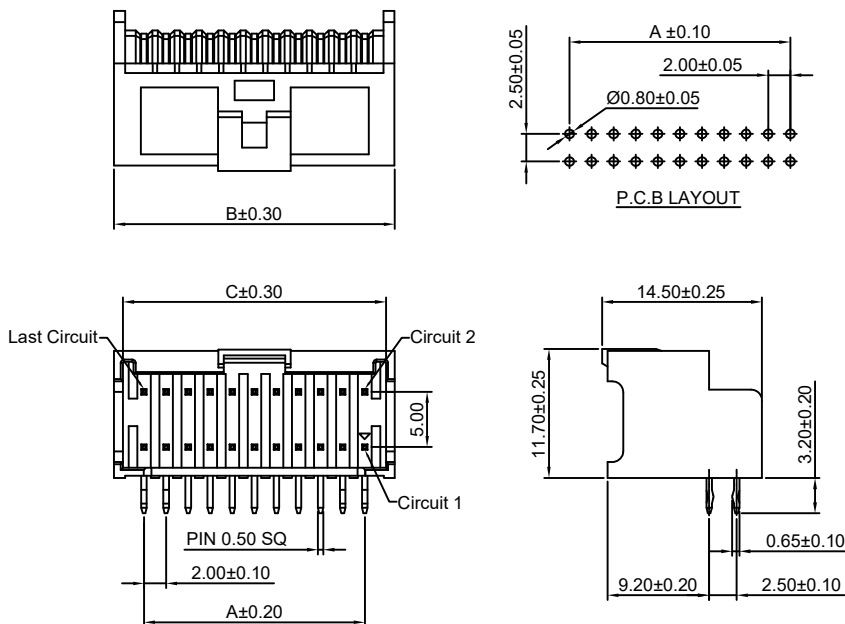

Ordering Information & Dimensions:

PART NO.	Dimensions		
	A	B	C
2x4P	6.00	11.40	9.80
2x5P	8.00	13.40	11.80
2x6P	10.00	15.40	13.80
2x7P	12.00	17.40	15.80
2x8P	14.00	19.40	17.80
2x9P	16.00	21.40	19.80
2x10P	18.00	23.40	21.80
2x11P	20.00	25.40	23.80
2x12P	22.00	27.40	25.80
2x13P	24.00	29.40	27.80
2x14P	26.00	31.40	29.80
2x15P	28.00	33.40	31.80
2x16P	30.00	35.40	33.80
2x17P	32.00	37.40	35.80
2x18P	34.00	39.40	37.80
2x19P	36.00	41.40	39.80
2x20P	38.00	43.40	41.80

Unit: mm